

Square Meters					
Store Name		Dumbarton			
Store Number		1169			
Number Of Units	Bay/Fixture	Height	Width	Depth	M2
0	Side Rack	1720	610	300	0.00000
Total Display Units Capacity					0.00000
0	1000 Fixture	1410	1000	470	0.00000
1.00	800 Fixture	1410	1206	470	1.70046
2.00	Kiosk Kit	1800	1000	300	3.60000
0.00	1250 Panama fridge bay	1800	1250	750	0.00000
0.00	937 Panama fridge bay	1800	937	750	0.00000
2.00	1250 Pearl M fridge bay	1800	1250	750	4.50000
0.00	937 Pearl M fridge bay	1800	937	750	0.00000
Total Shelving Capacity					9.80046
Miscellaneous BWS Display Base					
Visible Display	Display Base	2200	610	610	0.00000
Total Department Capacity					9.80046

Key - Drawing Information

- FIXTURE LICENCED FOR SALE OF ALCOHOL - ACCESSIBLE
- FIXTURE LICENCED FOR SALE OF ALCOHOL - INACCESSIBLE
- BOUNDARY OF PREMISES SALES FLOOR
- LOCATION OF PREMISES ON SITE PLAN

Key - Fire Symbols

- NOTICE - 'FIRE DOOR-KEEP CLOSED'
- NOTICE - 'KEEP LOCKED'
- ILLUMINATED EXIT DIRECTION
- EXIT SIGN
- EMERGENCY LIGHTING
- FIRE ALARM CALL POINT
- AUDIBLE WARNING
- SMOKE DETECTOR
- SMOKE DETECTOR
- ALARM INDICATOR PANEL
- DOORS FITTED WITH PUSH BARS
- DOORS FITTED WITH PRESSURE RELEASE
- FLOOR SHUTTER DOOR
- FIRE EXTINGUISHER - WATER TYPE
- FIRE EXTINGUISHER - FOAM TYPE
- FIRE EXTINGUISHER - CARBON DIOXIDE
- FIRE EXTINGUISHER - DRY POWDER TYPE
- FIRE EXTINGUISHER - AQUEOUS SOLUTION
- FIRE EXTINGUISHER - VAPOURISING LIQUID
- FIRE BLANKET
- FIRE HOSE REEL
- FIRE RESISTANT WALLS
- FIRE RESISTANT DOORS

NOTES:

- FIRE FIGHTING EQUIPMENT & ALL OF THE REQUIREMENTS OF THE FIRE SERVICE WILL BE INCORPORATED & WILL BE PROVIDED TO COMPLY WITH THE EUROPEAN STANDARDS

No. BSEN3 & BS2963.

FIRE STANDARDS:

- FIRE SAFETY RELATED SIGNS AND NOTICES ARE TO THE HEALTH AND SAFETY (SAFETY SIGNS & SIGNALS) REGULATIONS ACT 1996. THOSE THAT COMPLY TO BS 5499, PART 1, 1990 ALSO COMPLY.
- ILLUMINATED 'EXIT' SIGNS ARE TO CONFORM TO BS2560
- FIRE FIGHTING EQUIPMENT IS TO COMPLY WITH EUROPEAN STANDARDS BS EN3 AND BS 7863

NOTE:
TOTAL ALCOHOL DISPLAY AREA:
09.80046m²

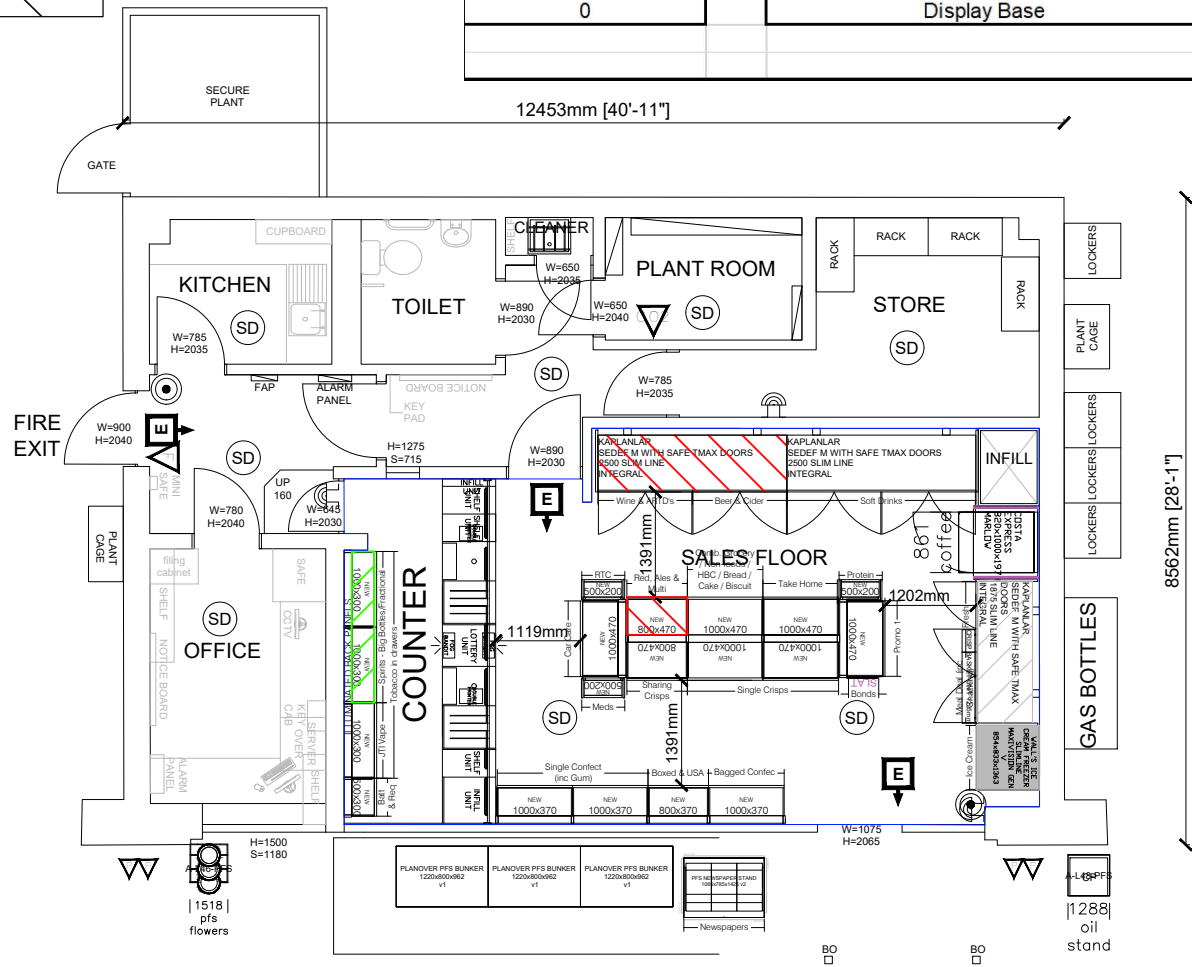

PFS

1169 DUMBARTON GLASGOW RD
GLASGOW ROAD DUMBARTON G82 1QZ
SALES FLOOR
RETAIL SALES AREA 490 Sq. Ft.
Scale: 1:100
only scaled on **A3**
mfg
motor fuel group